



Cox Voice Battery Casing Battery Installation and Replacement

What You'll Need

- Cox Voice Battery Casing
- Panoramic Wifi Gateway PW7 or above
- Six 6V Spring Terminal Lantern Batteries (See the approved batteries at: www.batteryjunction.com/gateway-battery.html)

How to Install the Batteries

Before proceeding:

- Ensure the Cox Voice Battery Casing is disconnected from both the Gateway and the Gateway's External Power Supply.
- All batteries must be new and the same type of battery from the same manufacturer. Do NOT mix batteries. Do NOT use old and/or used batteries.
Warning: Risk of explosion if incorrect battery type is installed

Is this your Gateway?

Make sure your Gateway looks like the image to the right.



Is this your Voice Battery Casing?

Make sure your Voice Battery Casing looks like the image to the right.



- 1 Loosen the screws on both corners of the Voice Battery Casing.



- 2 Lift both "tabs" of the Voice Battery Casing lid at the same time.

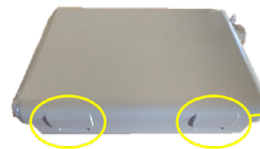

- 3 Open the Voice Battery Casing lid.



- 4 Remove the plastic caps from the spring terminals on the batteries, if applicable.



How to Install the Batteries (continued)

- 5 Align the battery with the corresponding polarity (+/-) as marked on the Voice Battery Casing.

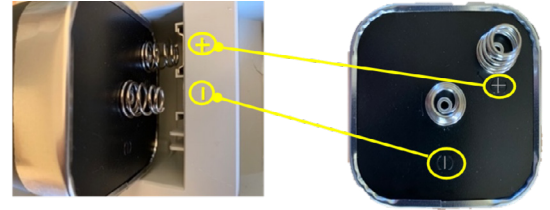

To the right, note the proper rotation of the battery by following the insertion illustrations. Ensure the (+) terminal is **below** the (-) terminal when inserting into the battery slot.

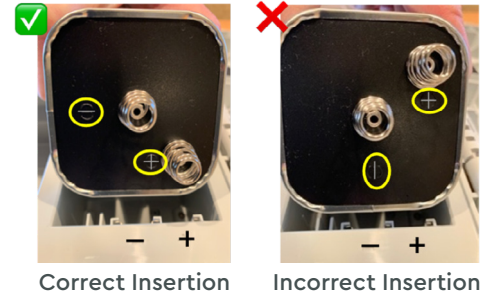

- 6 Press down on the terminals side first and then the other side to secure into place. Ensure the springs are making proper contact with both (+/-) terminals.

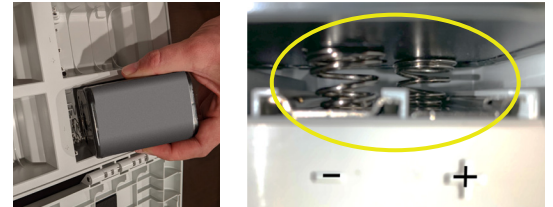

- 7 Insert all six batteries as indicated above.
Close the Voice Battery Casing lid.



- 8 Finger tighten the screws on both corners of the Voice Battery Casing.
The Voice Battery Casing is ready to be connected to your Gateway.



- 9 Follow the Getting Started Guide for activation instructions of the Cox Voice Battery Casing.



Important

- DO NOT open the Voice Battery Casing lid to replace the batteries while the Voice Battery Casing is in backup power mode. Doing so will cut off power to the Gateway. Please wait until AC power is restored to the Gateway.
- DO NOT reboot or power cycle the Gateway while the Voice Battery Casing is in backup power mode. Doing so will reduce the length of service time of the Voice Battery Casing.
- Place your Voice Battery Casing on a level surface in a dry location. Ensure the Voice Battery Casing and Gateway are not located near any heat sources. DO NOT place the Gateway or the Voice Battery Casing directly on the floor.

How to Replace the Batteries

Before proceeding:

- To avoid disruption in service and maximize battery life, only replace the batteries when there is no power outage. The Gateway must be running on AC power (not in battery backup mode) during battery replacement.
- Disconnect the Gateway and the Gateway's External Power Supply from the Voice Battery Casing.
- All batteries must be new and the same type of battery from the same manufacturer. Do NOT mix batteries. Do NOT use old and/or used batteries.

- 1 Loosen the screws on both corners of the Voice Battery Casing.



- 2 Lift both "tabs" of the Voice Battery Casing lid at the same time.

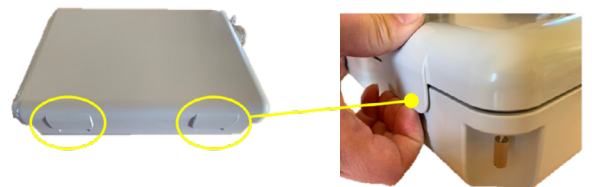

- 3 Open the Voice Battery Casing lid.

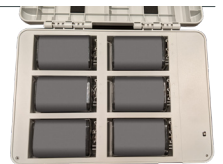

- 4 Remove all six batteries and dispose of them properly.



- 5 Remove the plastic caps (if any) from the spring terminals on the new batteries.



- 6 Align the battery with the corresponding polarity (+/-) as marked on the Voice Battery Casing.

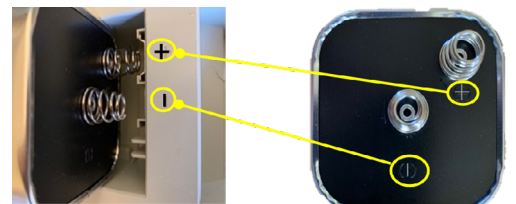

To the right, note the proper rotation of the battery by following the insertion illustrations. Ensure the (+) terminal is **below** the (-) terminal when inserting into the battery slot.

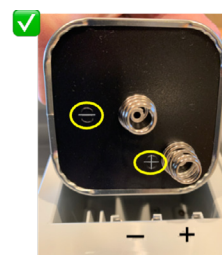

Correct Insertion

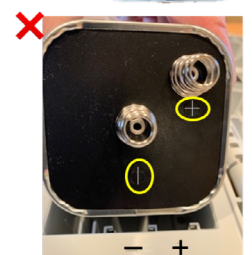

Incorrect Insertion

How to Replace the Batteries (continued)

- 7 Press down on the terminals side first and then the other side to secure into place.



- 8 Insert six new batteries as indicated above and close the Voice Battery Casing lid.



- 9 Finger tighten the screws on both corners of the Voice Battery Casing.



- 10 Reconnect the Gateway and the Gateway's External Power Supply to the Voice Battery Casing



Need Help?

Find additional information at [cox.com/battery](https://www.cox.com/battery) or contact a customer service expert at 1-800-234-3993.

Help Protect Our Environment:

Please recycle your batteries properly. For your convenience, batteries are accepted at no charge for recycling at various locations. Please check www.call2recycle.org or call 1-800-8-Battery (1-800-8-228-8379) for a battery recycling location near you.